

Eisenhour Church Furnishings

1137 Cleveland Rd. E. • P.O. Box 489 • Huron, OH 44839
1-800-686-0587 or 419-433-8071 • FAX 419-433-7559

HOW TO... Replace Kneeler Legs

The installation of replacement legs on Atwood-Hamlin Kneelers is simple. You don't even have to disconnect the kneeler from the pew. A reversible power screwdriver with a #2 Phillips bit will make the job go even faster.

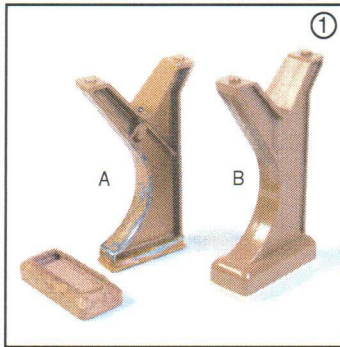

① 1. Shown at the left is the old metal leg with a detached rubber foot,[®] as well as a new plastic leg with securely attached rubber foot.[®] This new leg has a lifetime guarantee.

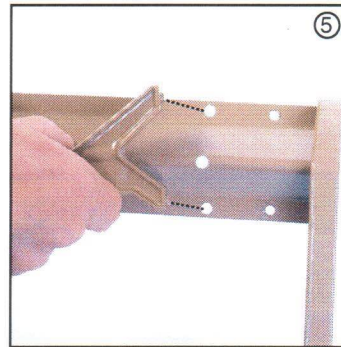

⑤ 5. Replace with the new leg using the screws provided. (Note the circular tabs on the top of the replacement leg. They should be inserted in the holes on the support bar where the old leg was removed.)

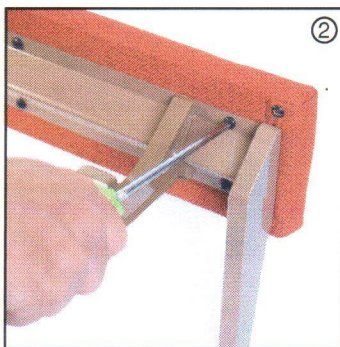

② 2. First, put the kneeler in the up position. Remove the screws that attach the kneeler pad to the V-shaped metal support bar.

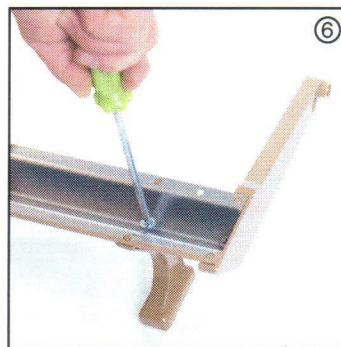

⑥ 6. Fasten the new leg to the support beam using the screws provided with the new legs. (Do not use the screw from the old leg.)

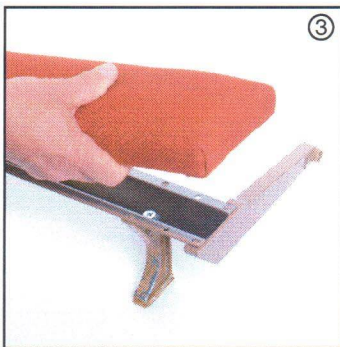

③ 3. Next, lift off the kneeler pad.



⑦ 7. Replace the kneeler pad on the support bar.

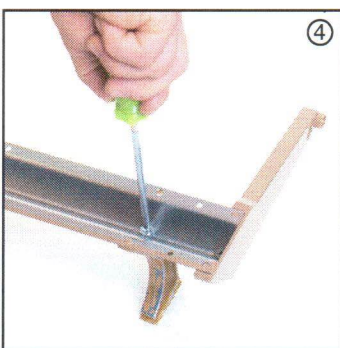

④ 4. Remove the screw that attached the old leg to the support bar and remove the leg.

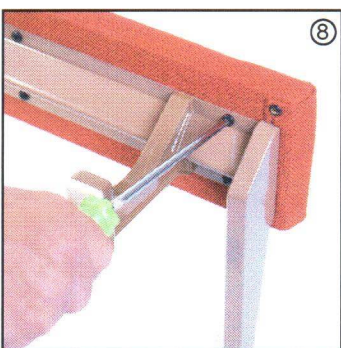

⑧ 8. Finally, refasten the kneeler pad to the support beam.